

# Estructuras MK

La estructura versátil para la Obra Civil

## Elementos básicos

	PESO (kg)	CÓDIGO
<b>Riostras</b>		
MK-120 1,125	29,4	1990209
MK-120 1,375	35,4	1990211
MK-120 1,625	41,9	1990213
MK-120 1,875	48,3	1990215
MK-120 2,125	54	1990217
MK-120 2,375	60	1990219
MK-120 2,625	69	1990221
MK-120 3,125	81	1990225
MK-120 3,625	93	1990229
MK-120 4,125	108	1990233
MK-120 4,625	120	1990237
MK-120 4,875	126	1990239
MK-120 5,625	147	1990245

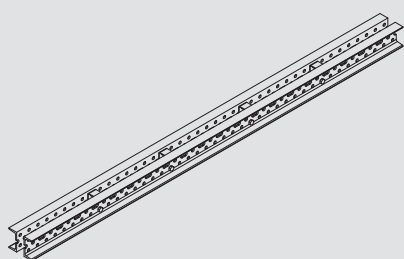

<b>Nudo</b>		
180 MK	30,8	1990485
180 D40 MK	31,8	1990480
120 MK	24	1990420
90 MK	18,8	1990390
60 F MK	16	1990360
60 M MK	21,4	1990361
AXIAL MK	15	1990300

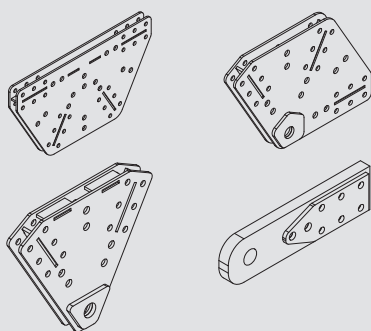

<b>Tensores</b>		
Tensores E (desde 0,35 m a 4 m)		

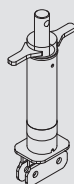

Tensores V (desde 0,27 m a 1,1 m)

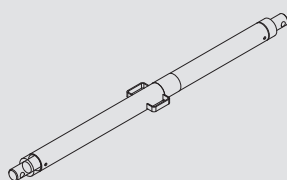

	PESO (kg)	CÓDIGO
<b>Unión longitudinal MK</b>	27,4	1990503

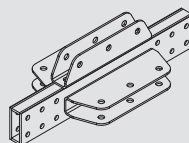

<b>Unión testa MK</b>	25,9	1990504
-----------------------	------	---------

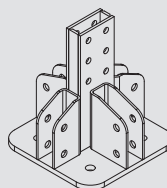

<b>Cabeza regulable MK</b>	34,2	1990594
----------------------------	------	---------

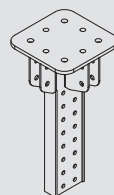

<b>Unión intermedia MK-120</b>	8,6	1990501
<b>U eje principal MK</b>	3,8	1990513
<b>U eje secundario MK</b>	3,8	1990521

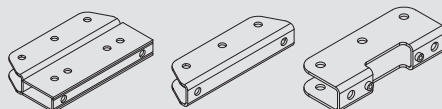

<b>Diagonal MK</b>		
1 x 1/1110	6,1	1990611
0,75 x 1,5/1396	7,7	1990614
1 x 1,5/1508	8,3	1990615
1,5 x 1,5/1818	10,1	1990619
1,5 x 2/2201	12,2	1990622
2 x 2/2525	17,2	1990625
1,5 x 2,5/2624	17,9	1990626
0,75 x 3/2845	19,4	1990628
2 x 2,5/1 x 3/2900	19,7	1990629
1,5 x 3/3071	20,9	1990630
2 x 3/3310	22,5	1990633

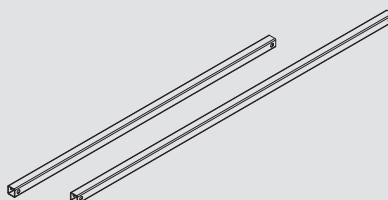

	PESO (kg)	CÓDIGO
<b>Montante horizontal MK</b>		
0,75/550	1,9	1990605
1/800	2,7	1990608
1,5/1300	4,5	1990613
2/1800	6,2	1990618
2,5/2300	7,9	1990623

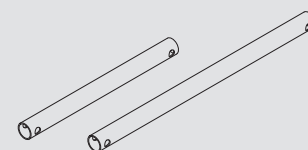

<b>Arriostamiento V cercha</b>	19,5	1990404
--------------------------------	------	---------

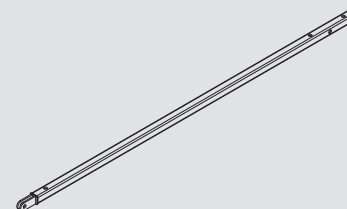

<b>Perfil husillo MK</b>		
0,5/1000	115	1990530
1/1500	161	1990551
1,5/2000	207	1990552
2/2500	253	1990553

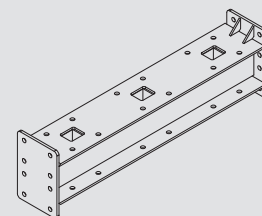

<b>Husillo base</b>		
360 MK	40,2	1990550
150 MK	35,5	1990515

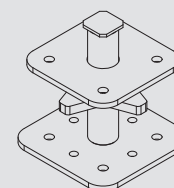

<b>Rueda</b>		
100 MK	89	1990655
25 MK	19,3	1990660

